

Drawn By: MEH
Project # WM-05-20

DANE COUNTY CERTIFIED SURVEY MAP

DRAFT

**A part of the SW 1/4 of the SW 1/4 of Section 17, T.7N., R.7E.,
Town of Cross Plains, Dane County, Wisconsin.**

SURVEYOR'S CERTIFICATE:

I, Matthew E. Hoglund, Registered Land Surveyor, do hereby certify to the best of my knowledge and belief, that I have surveyed, divided, and mapped the following Certified Survey being a part of the Southwest one-quarter of the Southwest one-quarter of Section 17, Township 7 North, Range 7 East, Town of Cross Plains, Dane County, Wisconsin, being more particularly described as follows:

COMMENCING at a found 1" iron pipe at the Southwest corner of said Section 17; thence, along the West line of said Southwest 1/4, North 00°52'43" East, 510.02 feet to a point on the Northerly line of Lot 1 of Certified Survey Map (CSM) No. 12337; thence, along said Northerly line, North 63°17'08" East, 24.39 feet to a found 1" iron pipe; thence, continuing along said Northerly line, North 66°07'33" East, 86.61 feet to the **POINT OF BEGINNING**;

thence, along a line parallel to said West line of the Southwest 1/4, North 00°52'43" East, 420.00 feet;

thence North 66°27'55" East, 619.33 feet to a point on the East line of the West one-half of said Southwest one-quarter of the Southwest one-quarter;

thence, along said East line, South 00°51'24" West, 508.00 feet found 5/8" iron rod at an angle point in the Westerly line of Lot 1 of CSM 13308;

thence, along said East line and said Westerly line, South 00°53'45" West, 450.66 feet to the Southwest corner of said Lot 1 of CSM 13308, lying on the Northerly right-of-way line of Jim Garfoot Circle per Document No. 1733048;

thence, along said Northerly right-of-way line, South 80°09'45" West, 134.26 feet to its intersection with the East line of aforesaid Lot 1 of CSM 12337, said point lying North 00°53'53" West, 5.12 feet from a found 1" iron pipe at the Southeast corner of said Lot 1 of CSM 12337;

thence, along last said East line, North 00°53'53" West, 506.94 feet to a found 1" iron pipe at the Northeast corner of said Lot 1 of CSM 12337;

thence, along aforesaid Northerly line of Lot 1 of CSM 12337, South 66°07'33" West, 476.00 feet to the **POINT OF BEGINNING**, containing 304,982 square feet or 7.001 acres, more or less, and is subject to all matters of record and/or fact.

I further certify, to the best of my knowledge and belief, that this map is a correct representation of all exterior boundaries of the land surveyed and the subdivision thereof made; that I have made such survey, land division, and map by the direction of William A. Ibach, Trustee of the William A. Ibach, and Marilyn J. Ibach 1998 Revocable Trust, the owner of said land; that I have fully complied with the provisions of Chapter 236.34 of the Wisconsin State Statutes and the Land Division Ordinance of Dane County and the Town of Cross Plains in surveying, dividing, and mapping the same.

Dated this 15th day of November, 2021.

Quam Engineering, LLC
By: Matthew E. Hoglund
P.L.S. S-1910

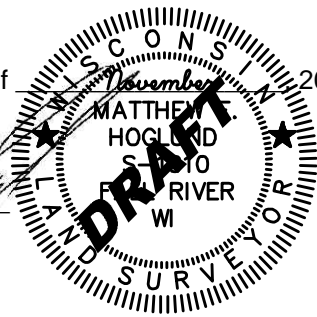

TOWN OF CROSS PLAINS BOARD CERTIFICATE:

Resolved, that this Certified Survey Map is hereby approved and dedications accepted by the Town Board of the Town of Cross Plains.

Dated this ___ day of _____, 2021.

Nancy Meinholz, Town Clerk

C.S.M. No. _____

Doc. No. _____

Vol. _____ Page _____

Drawn By: MEH
Project # WM-05-20

**DANE COUNTY
CERTIFIED SURVEY MAP #**

**A part of the SW 1/4 of the SW 1/4 of Section 17, T.7N., R.7E.,
Town of Cross Plains, Dane County, Wisconsin.**

DRAFT

OWNER'S CERTIFICATE:

We, William A. Ibach and Marilyn J. Ibach, as Trustees of the William A. Ibach, and Marilyn J. Ibach 1998 Revocable Trust, as owners, do hereby certify that we caused the land described on this Certified Survey Map to be surveyed, divided, mapped, and dedicated as represented on this Certified Survey Map. We also certify that this Certified Survey Map is required by Sec. 75.17(1)(a), Dane County Code of Ordinances, to be submitted to the Dane County Zoning and Land Regulation Committee for approval.

IN WITNESS WHEREOF, the William A. Ibach, and Marilyn J. Ibach 1998 Revocable Trust, have caused these presents to be signed at _____, Wisconsin, on this _____, day of _____, 20__.

In the presence of: _____
William A. Ibach, Trustee Marilyn J. Ibach, Trustee

STATE OF WISCONSIN)
COUNTY DANE) SS

Personally came before me this ___ day of _____, 20__, William A. Ibach and Marilyn J. Ibach, to me known to be the persons who executed the foregoing instrument and acknowledge the same.

(Notary Seal) _____ Notary Public, _____, Wisconsin

My commission expires _____.

DANE COUNTY PLANNING AGENCY APPROVAL:

This Certified Survey Map is hereby approved by the Dane County Zoning and Land Regulation Committee this ___ day of _____, 20__.

Daniel Everson, Authorized Representative

DRAFT

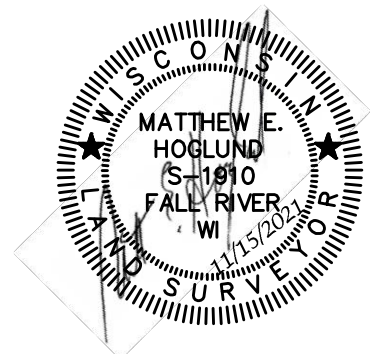

REGISTER OF DEEDS CERTIFICATE:

Received for recording this ___ day of _____, 20__, at _____ o'clock __ M. and recorded in Volume _____ of Certified Survey Maps on Pages _____ as Document No. _____.

Kristi Chlebowski, Dane County Register of Deeds

C.S.M. No. _____

Doc. No. _____

Vol. _____ Page _____