



Dana Radavich <dradavich@gmail.com>

Radavich-Adler Observatory Rd - Land division

3 messages

Dana Radavich <dradavich@gmail.com>
To: tadler@tds.net

Thu, Oct 29, 2020 at 10:31 PM

Hello Tom,

We are preparing the revision to our original rezone application to the Town of Cross Plains and to Dane County. We had a brief conversation with Greg Hyer, Town Board Chairman, about this. He requested a sketch of the proposed division and the impact on the current zoning. He also requested that you provide a note acknowledging your knowledge of this division and rezoning requirement with your approval.

We have attached the sketch and the proposed rezoning summary below. Would you take a look at this and let us know if this is what you were expecting and if this is ok with you?

After the rezone is approved, John Halverson will be able to submit the final CSM for the resulting lot combination.

REF: Rezone petition DCPREZ-2020-11616

**Attached: DCiMap showing the parcel divisions to be joined to neighboring properties
Final CSMs to be submitted after rezone approval**

Property Owners:

Dana and Lori Radavich, 528 Burnt Sienna Dr, Middleton, WI 53562, 608-640-6425 dradavich@gmail.com

Tom Adler, 4062 Observatory Rd, Cross Plains, 53528, tadler@tds.net

Surveyor Information:

John Halverson, Halverson Land Surveying, 501 Oak St, Arena, WI 53503, 608-753-2498,
john@halversonsurveying.com

Parcel information in Township of Cross Plains

Owner	Parcel Numbers	Acreage (1)	Current Zoning	Proposed Zoning
Radavich	0707-164-8500-4	SW 10	FP35	RR8
Radavich	0707-163-8349-9	0.8	FP35	
Radavich	0707-164-8500-4	E 20	FP35	RM16
Adler	0707-164-9085-0	15	RM8	

(1) Acreage is approximate until the certified survey map is completed.

Let us know if you have any questions or suggestions. If you can email "looks good to me" by this weekend, we will send it over to TCP Planning Commission early next week. They will discuss it at the meeting on Monday Nov 9th, then the Town Board on Thursday the 12th. The County ZLR meeting is in December and we are hoping to have the preliminary CSMs from Halverson by early November to submit for that review.

We are also expecting the legal description from John Halverson soon to proceed with the purchase contract.

Thanks
Dana and Lori

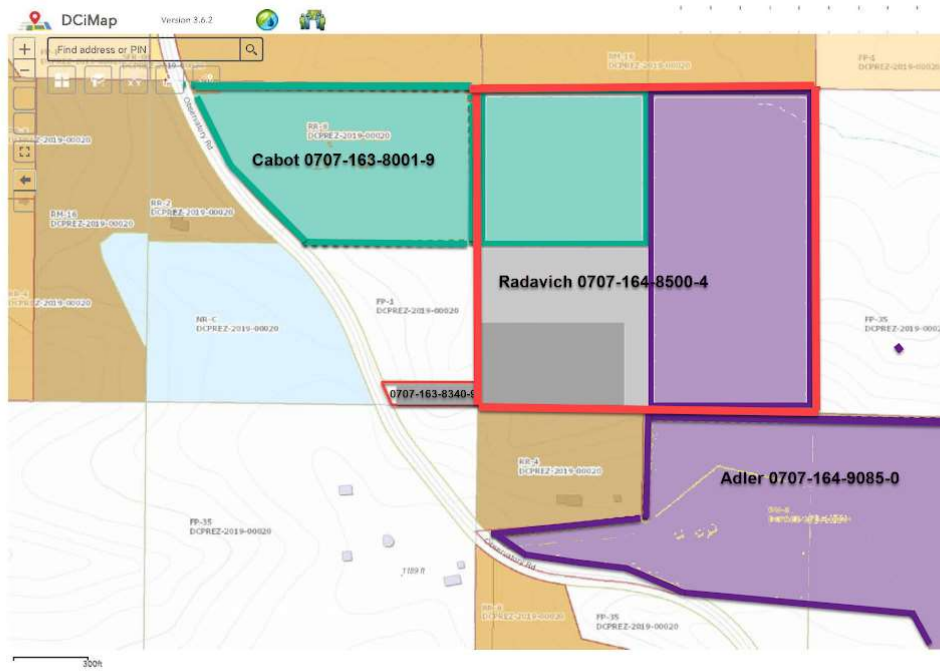

https://dcimapapps.countyofdane.com/demapviewer/?find=070716485004

10/13/2020

Dana Radavich <dradavich@gmail.com>
 To: tadler@tds.net

Fri, Oct 30, 2020 at 8:15 AM

Hi Tom,
 Just in case the embedded pic isn't legible, here it is attached as well.

Thanks
 Dana and Lori

[Quoted text hidden]



2020-10-30 Radavich Land Division DCiMap-Section 0707-16 Town of Cross Plains.jpg
 199K

Tom Adler <tadler@tds.net>
 To: Dana Radavich <dradavich@gmail.com>

Fri, Oct 30, 2020 at 12:39 PM

Dana and Lori,

Yes, that rezoning of my current parcel, plus the additional 20 acres, to RM-16 seems appropriate. I'm good with that.
 Thanks.

My offer to purchase is mostly drafted. So, I could proceed with that whenever the surveyor provides the legal description for the 20 acres.

I hope that all of your meetings/approvals go smoothly! Let me know if you need anything else from me.

Thanks,

Tom

[Quoted text hidden]

[Quoted text hidden]

[Quoted text hidden]

[Quoted text hidden]

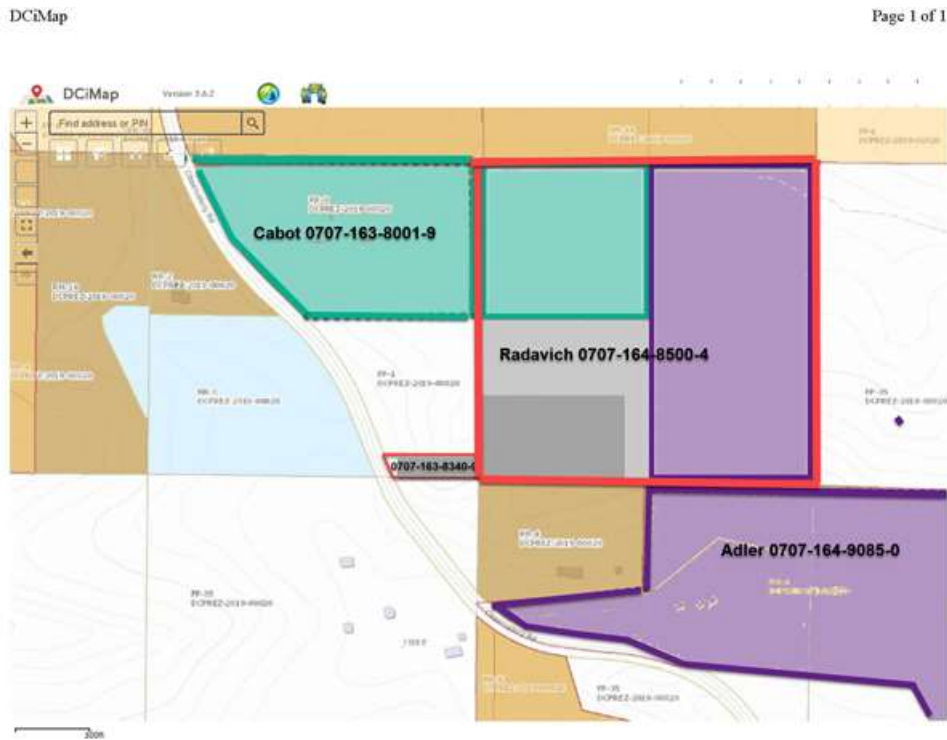

<https://dcimapapps.countyofdane.com/demapviewer/?find=070716485004>

10/13/2020